



The All New!

RoadWorks®

Detail Products



Complete 6 Bottle Set Includes

Metal Polish & Sealant | Paint Protectant | Spray Detailer
Truck Wash | Tire Shine | Bug Off

www.roadworksmfg.com



RoadWorks Manufacturing. Truck Accessories are available through authorized dealers

1-800-448-8741

Hours of Operation
Monday-Friday: 7am -6pm EST
3565 East 300 North
Lafayette, IN 47905

Let Us Help You Take Your Ideas &
“GET IT MADE”!



   @ROADWORKSCUSTOM / @ROADWORKSMFG

1.800.448.8741 / ROADWORKSCUSTOM.COM / ROADWORKSMFG.COM



CUSTOM
ROADWORKS PRODUCTS

DEALER LOYALTY PROGRAM

*At the end of the year
we will notify dealers who pass
the following benchmarks:*

BRONZE: \$3,000/year
Receives a \$150 Account Credit

SILVER: \$6,000/year
Receives a \$450 Account Credit
& Small RoadWorks Custom Counter-top Sign

GOLD: \$15,000/year
Receives a \$1,500 Account Credit,
Small RoadWorks Custom Counter-top Sign
& a RoadWorks Custom Banner

STAINLESS: \$30,000/year
Receives a \$3,500 Account Credit,
Small RoadWorks Custom Counter-top Sign,
RoadWorks Custom Banner & a RoadWorks Custom Bench



HINO MODEL 338 - 12" DROP VISORS (Kit)

Blank (0)	991100	N991100
Supernova (8)	991101	N991101
Crew (8)	991103	N991103
2" Round Flat (12)	991104B	N991104B
2" Round Beehive (12)	991105B	N991105B
Challenger (12)	991109B	N991109B
Bulls-Eye (12)	991110B	N991110B
3/4" Button (12)	991110GB	N991110GB
Fusion (12)	991111BC	N991111BC
M1 (8)	991101M1	N991101M1
M3 (12)	991104M3	N991104M3
M5 (12)	991109M5	N991109M5
A. Mini (12)	991109MN	N991109MN

1" FACE CAB PANELS (Pair)

Fits Hino Model 338.

Blank (0)	991000	N991000
B. 1 - Mini (6)	991001	N991001
Bulls-Eye (6)	991002	N991002
3/4 Button (6)	991003	N991003

2 - For Hino DPF/DEF Cover - Call RoadWorks Customer Service at 1-800-448-8741 for more information.

HINO MODEL 338 - PUNCHED INTAKE SCREEN

Replace XX in the part number with a style from the punch options table below. (Part # 990010-23 Shown)

Punched Intake Screen (Kit)
C. 990010-XX N990010-XX

PUNCH OPTIONS

View punch styles page 339.

-23	Small 1/4" Circles (Shown)
-24	Large 7/16" Circles
-28	Hexagons
-30	Horizontal Rectangles
-31	Vertical Rectangles
-32	5/16" In-Line Squares
-33	5/16" Offset Squares
-36	Horizontal Ovals
-37	Vertical Ovals
-38	Horizontal 3/16" Oblong
-39	Vertical 3/16" Oblong
-40	Horizontal 5/16" Oblong
-41	Vertical 5/16" Oblong
-46	Stars
-47	Snake Skin

HINO 338 - HOOD SIDE FENDER MARKER LIGHT TRIMS (Pair)

Oval Hood Side Fender Marker Light Trims
D. 990026 N990026
Flames Hood Side Fender Marker Light Trims
990027 N990027
Pointed Hood Side Fender Marker Light Trims
990028 N990028

HINO 338 - HOOD STRAP TRIMS (PAIR)

Hood Strap Trims
E. 990025 N990025



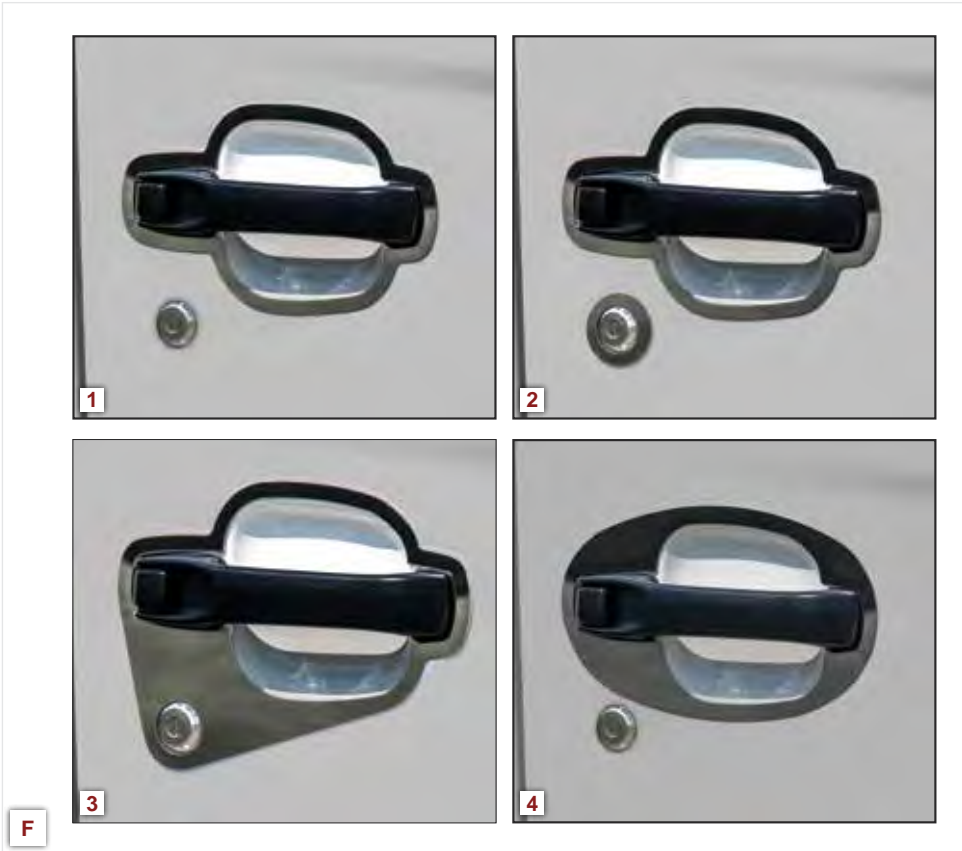

HINO 338 - DOOR HANDLE TRIMS

- F.** 1 - Handle Surround (Pair)
990000 N990000
-
- 2 - Handle Surround plus Lock Surround (4 Piece Kit)
990001 N990001
-
- 3 - Handle / Lock Surround (Pair)
990002 N990002
-
- 4 - Oval Handle Surround (Pair)
990003 N990003

HINO MODEL 338 - PUNCHED CENTER BUMPER FILLER PLATE

Replace XX in the part number with a style from the punch options table below.

Punched Center Bumper Filler Plate (Kit)
990022-XX N990022-XX

PUNCH OPTIONS

View punch styles page 339.

- 23 Small 1/4" Circles
- 24 Large 7/16" Circles
- 28 Hexagons
- 30 Horizontal Rectangles
- 31 Vertical Rectangles
- 32 5/16" In-Line Squares
- 33 5/16" Offset Squares
- 36 Horizontal Ovals
- 37 Vertical Ovals
- 38 Horizontal 3/16" Oblong
- 39 Vertical 3/16" Oblong
- 40 Horizontal 5/16" Oblong
- 41 Vertical 5/16" Oblong
- 46 Stars
- 47 Snake Skin



HINO 338 - BLANK BUMPER FILLER PLATES (Kit)

Blank - Center Bumper Filler Plate
990020 N990020

- G.** 1 - License Plate Holes - Center Bumper Filler Plate
990021 N990021

HINO 338 - FOG HOLE FILLER PLATES (KIT)

2 - Blank Fog Hole Filler Plates
990023 N990023

UNDER HEADLIGHT SPLASH TRIM

Fits Hino Model 338



- H.** 1 - Under Headlight Splash Trim (Pair)
990015 N990015